

N75ES

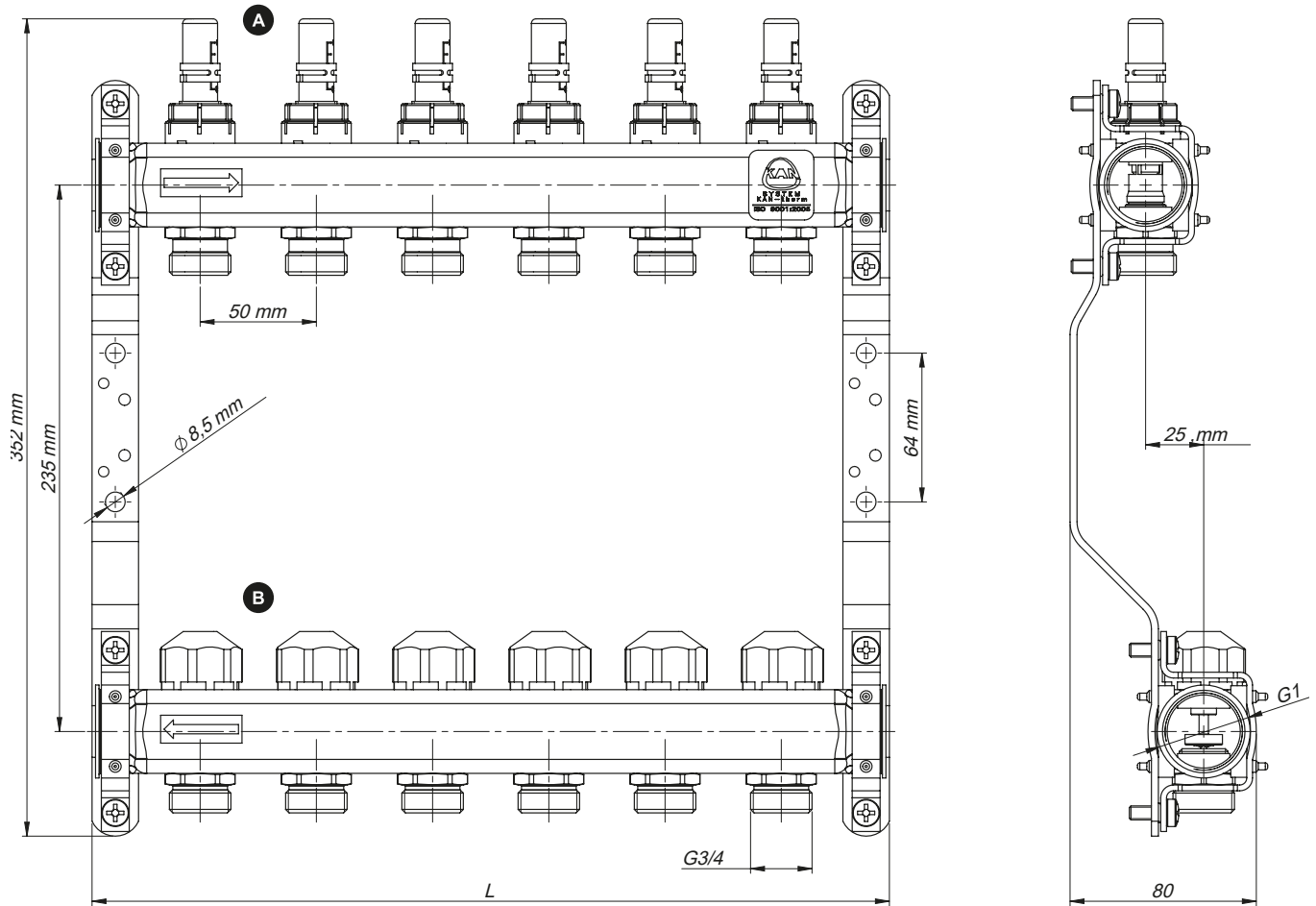

SYSTEM
KAN-therm



No	1316273011	1316273012	1316273013	1316273014	1316273015	1316273016	1316273017	1316273018	1316273019	1316273020	1316273021
L [mm]	196	246	296	346	396	446	496	546	596	646	696

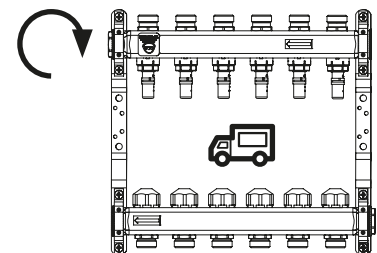

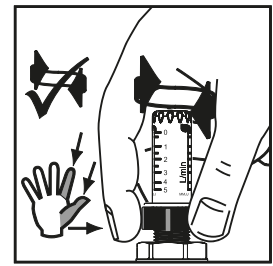
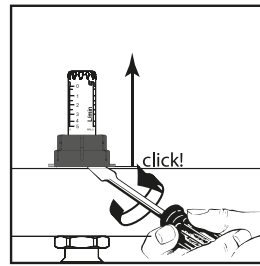
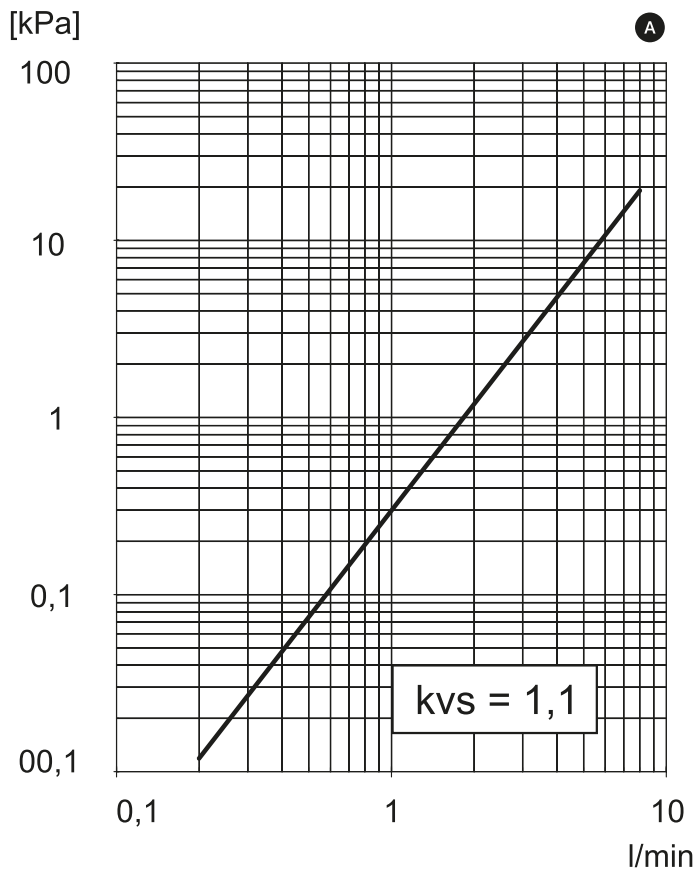

$T_{\max} = 70^{\circ}\text{C}$
 $p_{\max} = 6 \text{ bar}$
 $\text{H}_2\text{O} - 100\%$
 Glycol - max. 50%

